



DRIVING VIDEO RECORDER DR 850 INSTRUCTION MANUAL



Scan this QR code
More information on
HELLA Driving Video Recorders

Full HD
1080



DR 850 DRIVING VIDEO RECORDER INSTRUCTION MANUAL

BASIC COMPONENTS



Main Unit with Bracket



Rear Camera



Quick Start Guide



Direct Power Cable



SD Card Reader

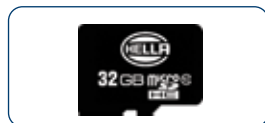

Micro SD Card



Cable Holder



Rear Camera Connection cable

DR 850 DRIVING VIDEO RECORDER INSTRUCTION MANUAL

PRODUCT OVERVIEW



- 1 LED Recording Light
- 2 Rear Camera Connection Slot
- 3 GPS Connection Slot
- 4 Power Connection Slot
- 5 Audio Recording and Format Micro SD Card
- 6 Micro SD Memory Card Slot

- 7 LED Recording Indicator
- 8 Flip Camera Recording Angle Orientation



DR 850 DRIVING VIDEO RECORDER INSTRUCTION MANUAL

PRODUCT SPECIFICATION

Image Sensor	Full HD CMOS Sensor
Audio input	Built-in Microphone
Video Compression	H.264
Audio Compression	ADPCM
Micro SD Card	Up to 128 GB Micro SD Card. Format free
Resolution	Front Camera Full HD (1080p) & Rear Camera HD (720p)
FPS	Max. 30fps
Angle View	Front Camera 145 Degrees & Rear Camera 120 Degrees
G-Sensor	3axis gravity sensor, event recording by External Shock
Speaker	Operation Status alarm / Voice guidance
Wi-Fi	Built-in Wi-Fi for mobile phone application
External GPS (Optional)	Synched with Google map, Keep track of location and Speed.
PC Viewer	Windows XP/7/8/10, Support 32Bit / 64Bit Supported over OSX 10.7 64Bit Synchronizing Google map with PC viewer is supported over Windows7 and explorer 10 as per Google's policy
Power	DC 12V- 24V
Allowable current of providing fuse	3A
Operation temperature	-20°C - 70°C
Dimension	110mm x 33mm (w/o bracket)

DR 850 DRIVING VIDEO RECORDER INSTRUCTION MANUAL

INSTALLATION

Memory Card Insert

Please ensure Micro SD Card Memory card is inserted correctly.

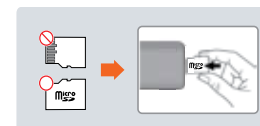

Product Installation

- 1 Ensure the Front Camera is fixed with the Mount Bracket provided.
- 2 Insert the memory card into memory card slot, and peel off the adhesive tape on the bracket.
- 3 Install the front camera at the front windshield by adjusting the angle.
- 4 Front angle may be different depending on car brand & model. For general vehicle, install the front angle vertically.

DR 850 DRIVING VIDEO RECORDER INSTRUCTION MANUAL

INSTALLATION

Product Installation

- 5 Connect wire cable to fuse box terminal in the car before connecting to dash camera.
- 6 Peel off the adhesive tape on the rear camera and place it on the rear windshields of the car.
- 7 It is recommended that you install the power cable towards the driver seat and rear camera connection cable towards the passenger seat to prevent interference of car navigation GPS.
- 8 To enable Parking Mode, do ensure proper wiring is done (check with installer).
- 9 Setting the dash camera to "acc" will disable parking mode and over-write parking mode settings in the mobile application.

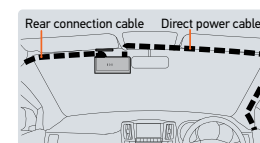

DR 850 DRIVING VIDEO RECORDER INSTRUCTION MANUAL

SMART PHONE CONNECTION

How to connect to Android and Apple iOS

- 1 Search and download HELLA DR 850 application in Apple Store / Google Play Store.
- 2 Turn on Wi-Fi function of smart phone and power up HELLA DR 850.
- 3 Select HELLA_DR850_XXXXXX in the Wi-Fi list.
- 4 Input password "12345678" and select "Join".
- 5 Once connected, open the HELLA DR 850 application.



DR 850 DRIVING VIDEO RECORDER INSTRUCTION MANUAL

SMART PHONE APPLICATION

Live View

Real time video of the Dash Camera

- 1 Turn On and Off voice recording.
- 2 Switch between front and rear camera.
- 3 Flip rear camera video.
- 4 Capture a photo.

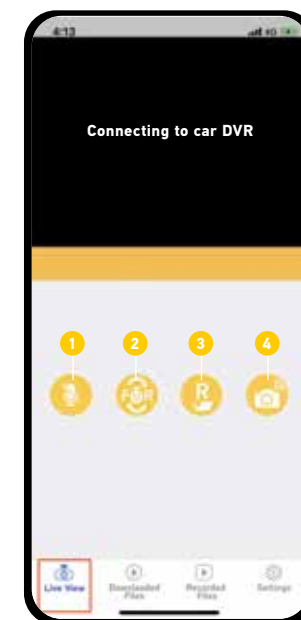

SMART PHONE APPLICATION

Recorded Files

Files stored in DVR SD Card

- Video Play Back: Select the desired clip to play back the video.
- Download Video/Photo: Select desired clip and click on the download button on the right. Files downloaded are found on the "Downloaded Files" tab.

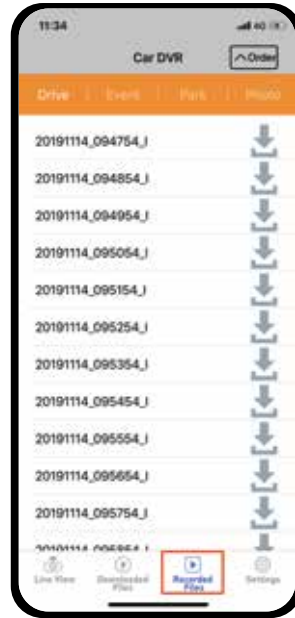

9

SMART PHONE APPLICATION

Settings

- 1 Change Wi-Fi Password (Default Password is "12345678").
- 2 Change the SSID of the Wi-Fi.
- 3 Selection between Full HD and HD.
- 4 Adjustment of the video frame rate.
- 5 Adjust impact sensor sensitivity.
- 6 Key voice volume.

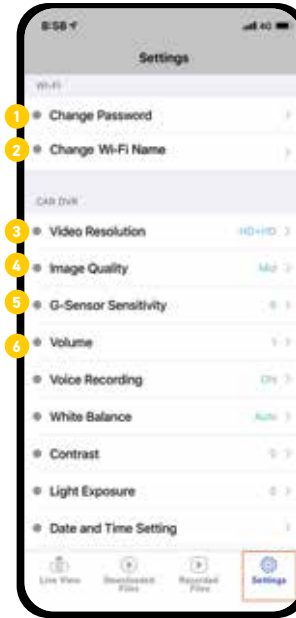

11

SMART PHONE APPLICATION

- 12 Alarm sound when an event is recorded.
- 13 Disconnect dash camera when power source voltage drops to certain level.
- 14 Impact sensor sensitivity in park mode.
- 15 Duration the dash camera will record while parked. Dash camera will automatically turn off once the time has elapsed. If "Off" is selected, recording will continuous.
- 16 Enable/disable voice instructions.
- 17 Turn on and off front LED light.
- 18 Ease all SD card content.
- 19 File storage partition options for Drive, Event, Park and Photo.
- 20 Revert to factory setting.
- 21 Dash camera firmware information and online manual.
- 22 APP version.

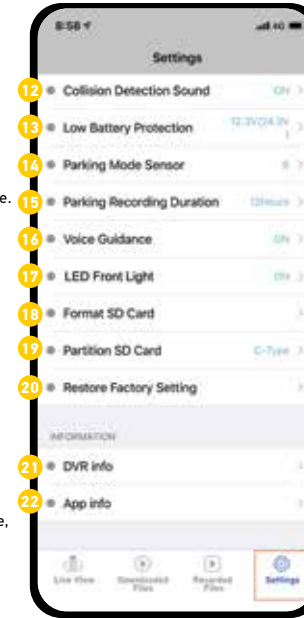

13

PRECAUTION

Voltage Issues

- Please use recommended/stable voltage only. Otherwise, improper use may cause product failure and fire accidents, explosion or damage to the vehicle.

Installation

- Do not mount dash cam on areas where it obstructs the driver's view or the operation of the vehicle itself.
- Do not install the device on colored or heavily tinted windshield as it may affect video quality.

Usage and General Management

- Image quality could deteriorate when the temperature of the device exceeds the optimal operating temperature.
- Please check whether the device is functioning before driving a car.
- Do not remove SD card or turn off the power cable during firmware update, it may cause malfunction or loss of data.
- For safety, do not operate dash cam while driving.

Memory Card and Precaution

- SD memory card stores information in flash memory, which has a limited service life. Periodic care and checking is required.
- The device must be turned off when ejecting the memory card. It may cause loss of data or malfunction of the memory card when user forces switch-off while it is running.
- Video data may be damaged due to a defective memory card or shorten lifetime of memory card.
- Genuine memory card is recommended to avoid error, incompatibility or malfunction of the product.
- Please check your memory card once every month for maintenance and stability. It is recommended that you check memory card through SD formatter program(www.sdcard.org).
- Please do not remove the SD card while the device is running or when it is being turned off.

15

SMART PHONE APPLICATION

Downloaded Files

Downloaded files are stored within HELLA DR 850 application

- Video/Photo Deletion: To delete a specific file, swipe left or press and hold. A confirmation message will appear.
- Video/Photo Sharing: To share or save the file within your smartphone. Press and hold the desired file for 2 seconds. Select your preferences in the pop-up window.



10

SMART PHONE APPLICATION

Settings

- 7 Recording of audio in video.
- 8 Recording white balance.
- 9 Recording contrast.
- 10 Recording light exposure.
- 11 Set up date and time.

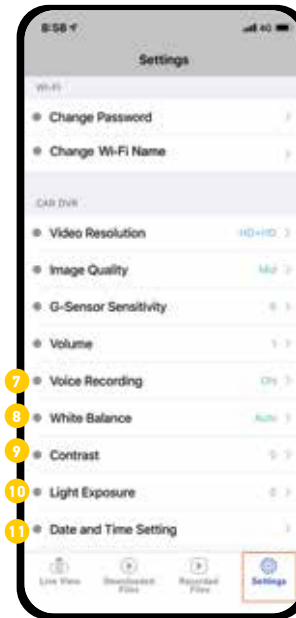

12

PC VIEWER / MEMORY CAPACITY

PC VIEWER

- Video recording can be view and downloaded in PC.
- Install PC Viewer using the following QR code.
- You can also download PC viewer from www.hellaasia.com



MICRO SD MEMORY CAPACITY AND RECORDING TIME

- Class 10 Micro SD card is recommended.
- It is recommended to change your Micro SD card every 6 months.

Micro SD Card Capacity	Estimated 2 Channel (Full HD + HD) Recording
16 GB	2h 30mins
32 GB	5h 15mins
64 GB	10h 45mins
128 GB	21h 45mins

14

DISCLAIMER

- The device is not intended to be used for illegal purposes and/or surveillance. It shall not be used in any form as evidence for claim purposes.
- Some countries prohibit drivers from mounting anything on the windshield, or restrict mounting to specific areas of the windshield. It is the owner's responsibility to mount the device in compliance with local laws.
- Errors may occur depending on the surrounding environment and the voltage of the car.
- Please check date / time if the device is not used for a long period of time.
- Though this product records and saves footages in the event of accident, it does not guarantee every single accident scenes are fully recorded.
- Accident scenes may not be recorded if there is minor impact on the vehicle as the impact sensor may not be able to detect.
- HELLA is not liable/responsible for non-recorded event, missing files, etc.
- In the event that the product is used as proof of accident, HELLA will not be responsible for any gain or loss caused by the accident.

16